

MOTORPOOL MESSENGER

Military Transport Association - North Jersey

February 1995

Peter B. Berendsen, Editor, 152 Rockwood Rd., Florham Park, NJ 07932

CALENDAR:

2/11-12 - Forks of the Delaware, Fairgrounds, Allentown
2/13/95 - Meeting, September's, East Hanover
3/11/95 - Meadowlands Militaria show, Union
3/13/95 - Pizza Party at Pistilli's, Bernardsville
4/10/95 - Meeting, September's
4/29/95 - Meadowlands Militaria show, Union
5/8/95 - Meeting, September's
5/13-14/95 - Forks of the Delaware, Fairgrounds, Allentown
5/19-20/95 - Aberdeen P. G. Spring rally
5/20/95 - Parade, Parsippany. This is the same weekend as Aberdeen. If you are able to participate in this tentative parade and will not be at Aberdeen, please call Al Axelrad at 201-884-0051 so that he can determine whether we should pursue the contract.

By now all members who owed dues should have paid the \$10 to Rick Frei. If you have not yet done so please call Rick and send the dues. If you do not do so we will assume that you are no longer interested and your name will be dropped from the mailing list and roster for 1995.

FOR SALE:

- (1) 1942 Script MB. Rebuilt engine, brakes. Converted to 12 volt. New 6-ply tires. Runs great.
- (2) M43 Field Jacket, 46-long, excellent condition, \$140.
- (3) WWII four-pocket tunics, size 44 reg. and 44 long, exc. cond. \$75-85 each.
- (4) WWII wool pants, size 42 and 44. exc. cond. \$50 each.
- (5) WWII WAC field jackets, exc. cond. size 10 reg & 12 reg. \$35 & 50 each.
- (6) WWII WAC and Army nurse trench coats, exc. cond. size 10 & 12 reg. \$40-50 each.
- (7) WWII WAC hoods for M43 field jackets, \$15 each.
- (8) WWII WAC wool tunics, exc. cond. size 10 & 12 reg, \$40 & 50 each.
- (9) WWII WAC wool shirts, exc. cond. \$25 each.

Call Lou between 6-10 pm EST weekdays at 201-887-0771.

M-37 end curtains, new in boxes, \$25 each. Cal. .30 ammo cans, exc. condition \$3 each. Call Marc Ziegler at 201-263-1923.

Jeep accessories, part 12. In the last installment of this feature we described the use of the body extension for carrying firewood (and other goodies). We concluded by noticing snow flakes. As I write this we have "A winter storm watch" for tomorrow. Will it happen? If we do have a snowstorm, how many of us will brave the icy roads to go to Tobyhanna? I had a neat list of items that I had hoped to find, but, I'll have to wait for Aberdeen. How about clearing the snow? Does your Jeep have a plow on it? My '45 (thanks to Harold) does. But with the plowing, suppose I snap a snoggin or bend a bort or some other such disaster? I enclose the exploded parts diagram for the Western plow. Maybe this will help identify the broken thing and put your unit back in action.

WESTERN SNOWPLOW FOR WILLYS JEEP

Dual Trip Spring Model

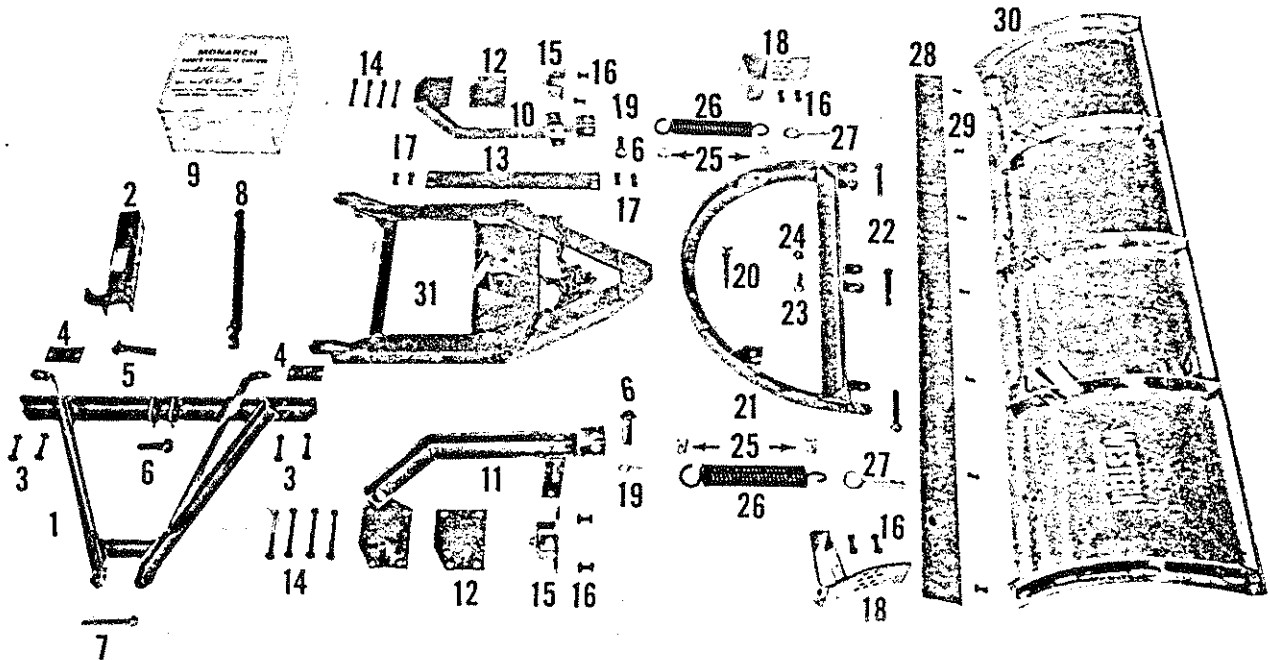

Ref. No.	Quan.	Part No.	Description	Ref. No.	Quan.	Part No.	Description
1	1	23009	Lifting Frame Ass'y	17	4		Machine Bolts & Nuts 1/2 x 1 1/2
2	1	23000-10	Lifting Channel Ass'y	18	2	23006	Shoe Ass'y—Skid Type
3	4		Machine Bolt 1/2 x 4 1/2	19	2	23051	Hair Pin Cotters
4	2	23009-9	Clamp Bar	20	1	23040	Clevis Pin 3/8
5	1		Rivet 1 x 4	(21)	1	23029	Quadrant Ass'y (3 point push)
6	3		Rivet 1 x 3	22	3		Rivets 3/4 x 4 1/2
7	1		Rivet 3/8 x 4 1/2	23	1	23007-10	Hex Head Cap Screw 3/4 x 2
8	1	801	Hydraulic Ram	24	1		Hex Nut—Slotted 3/4"
9	1	23044	Monarch Jeep Pump Kit (4 cyl.)	(25)	4	23042	Spring Clamp—1/2" malleable
10	1	23014-2	L.H. Pusharm Ass'y	(26)	2	23039	Spring (29342)
11	1	23014-1	R.H. Pusharm Ass'y	(27)	2	23043	Eyebolt—3/8 x 6
12	2	23014-11	Clamp Plate	28	1	23004-2	Wear Bar 6'
13	1	23014-12	Cross Bar	29	7		Carriage Bolts with Nuts 3/8 x 1 1/4
14	8		Machine Bolts & Nuts 1/2 x 3 1/2	(30)	1	23024-1	Blade (6')
15	2	23014-8	Spring Clip Ass'y	31	1	23007	"A" Frame
16	8		Machine Bolts & Nuts 1/2 x 1 1/4				

WESTERN WELDING & MFG. CORP.
Milwaukee 3, Wis.

September 1, 1956

INSTALLATION INSTRUCTIONS

WESTERN SNOWPLOW

FOR WILLYS JEEP SNOWPLOW

1. Mount Hydraulic Pump Kit Unit in accordance with instructions furnished with pump.
2. Mount left and right push arms by loosely bolting the mounting clamps around the vehicle frame at the point shown, using bolts (Item B) in Packing Bag. Now bolt the spring leaf mounting clamps around the spring leaves at a point approximately one inch in front of axle assembly. Be sure left and right push arms are in alignment to insure easy mounting of A-frame in step 6. Bolt push arm cross member to push arms, using bolts (Item F) in Packing Bag. Now tighten bolts of frame clamps and spring clamps.
3. Mount lifting frame to vehicle frame horns with U-bolts. To mount frame support arms to upper flange of bumper, drill two 7/16" holes in bumper top flange with bolts (Item C) in Packing Bag.
4. Assemble plow blade to quadrant with pins furnished.
5. Attach blade to Quadrant using pins furnished, and attach springs to blade using as much tension as necessary. (For New Englander Edge Trip Blade, fasten stiff links using furnished 5/8 bolts).
6. Mount A-Frame to push arms with pins furnished.
7. Depress hydraulic ram completely and place lift chain in notches of lift arms as shown, removing all slack from chain.
8. Attach hydraulic hose line to ram using fittings furnished. Use reducer fitting (Item A) in Packing Bag only if necessary.

Please note: When mounting hydraulic pump on 1957 Model Jeep, the Oil Filter should be mounted on the right hand fender skirt (generator side) instead of the left hand side as is done in 1956 and previous models.

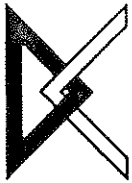

DONCAR EQUIPMENT CO. (Div. Doncar, Inc.)

"Military Vehicle Restorations"

P.O. Box 133, Flanders, NJ 07836 (Mailing)
38 Ironia Rd., Flanders, NJ 07836 (Shipping)

Tel: (201) 927-0940
Fax: (201) 584-8118

Doncar, Inc. continues to provide specialized restoration work on your vintage military equipment. Since initiating our venture last year we have provided unique services in the delivery of restoration projects for many clientele.

Body work, Metal fabrication, Welding, Sandblasting, Wiring, Painting, Detailing and Storage are offered at reasonable rates. We specialize in the restoration item that an owner finds difficult or does not have the tools to complete. We offer appraisals on your vehicle, and transportation as required.

Also, the following is a list we currently have available for sale or trade. Please call us at 201-927-0940 with your needs.

V E H I C L E S F O R S A L E

- 1) 1941 White Halftrack Serial # 293865, M16A1 with winch, no quad mount, all other accessories attached. good track, runs and drives, few extra parts, currently partially disassembled, sandblasted and primed, asking --- \$ 10,000.00
- 2) 1954 Dodge M-37 Serial # 80260619, restored, excellent running condition, shown often, hardtop, with .50 Cal. Browning Machine Gun, simulator operating, asking \$ 7,500 w/o gun, --\$ 9,500.00 with gun.
- 3) 1941 White Scout Car M3A1, unrestored and uncut except for skate rail (removed), most parts available, needs instruments, not running, asking-----\$ 9,000.00
- 4) 1955 M-100 Trailer, completely restored in Navy Grey, Grey canvas cover, as new, asking-----\$ 850.00
- 5) 1952 Dodge M-37 Serial # 80028253, 90% complete, sound tub, canvas top, little rust, will run, asking----\$ 1800.00
- 6) 1944 Dodge WC-51, # 81739019, French rebuild in 1952, sound condition, little surface rust, 95% plus complete, spare wheels, exhaust and other parts, runs excellent, undergoing restoration, when complete-----\$ 6800.00
- 7) 1953 Dodge M-43 Ambulance, prior USAF, Serial # 80053109, 95% + complete, runs excellent, 27,000 miles, straight fenders and bumpers, little box work needed, new batteries, great vendor vehicle, as is, \$ 2000.00, with paint, \$ 3500.00

All vehicles can be delivered or restored to your specifications.